

OUTLAW

MADE TO FIT
YOUR ADVENTURES



OUTLAW

 BY THOR MOTOR COACH

WHEN WE SAY *MADE TO FIT*,
WE MEAN IT.

With so many unique models available, Thor Motor Coach motorhomes are priced to fit anyone's budget – from families buying their first motorhome, to full-timers looking for a roaming “dream home”. No matter how you choose to spend your time or your money, there's a TMC motorhome that fits your needs. Welcome to the Outlaw, the motorhome that is *Made to Fit* your adventures.



29H | METALLIC | OLYMPIC CHERRY



29H | METALLIC | OLYMPIC CHERRY



35SG | COCKPIT



35SG | BROWN SUGAR | SYDNEY MAPLE



CLASS C



35SG | BROWN SUGAR | SYDNEY MAPLE

 **THOR**
MOTOR COACH
Made to fit.

BEAUTY INSIDE & OUT



BROWN SUGAR



CHILI PEPPER

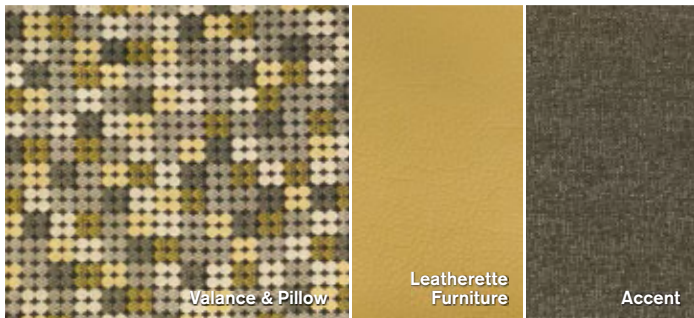

METALLIC

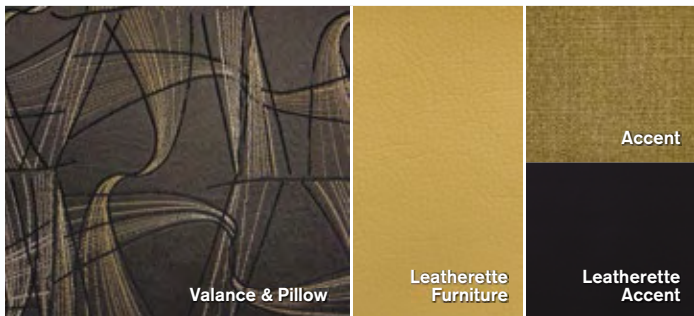

MOONDANCE



FLOORING & COUNTERTOPS



OLYMPIC CHERRY



SYDNEY MAPLE

CLASS C



AFTER BURNER HD-MAX™ **HD**



COLD FUSION HD-MAX™ **HD**

SUPER C



DREAM CATCHER FULL-BODY PAINT



LIQUID ASSET FULL-BODY PAINT



ROCK ISLAND FULL-BODY PAINT



TANGO RED FULL-BODY PAINT



AFTER BURNER HD-MAX™ **HD**



COLD FUSION HD-MAX™ **HD**

CLASS C – FORD® E-450
305HP & 420 LB.-FT. TORQUE

SUPER C – FORD® F-550
300HP & 660 LB.-FT. TORQUE



FORD® ENGINES

Engines with a proven track record of durability and low-hassle maintenance. The E-450 has a 6.8L Triton® V10 and the F-550 houses a 6.7L Power Stroke® V8 Turbo Diesel. Extremely smooth running with commanding horsepower and torque.

POWER 4-WHEEL DISC ANTI-LOCK BRAKE SYSTEM

Maintains brake balance in heavy use and varying road conditions. Reduces wheel lock up and helps maintain superior steering control.

TWIN I-BEAM FRONT SUSPENSION

Provides a comfortable ride by allowing the front wheels to work independently of each other, reducing driver stress.

TORQSHIFT™ AUTOMATIC TRANSMISSIONS

Provides crisp, firm and quick shifting without sacrificing driver comfort.

LIMITED WARRANTY

The Ford® Motorhome Chassis has a Bumper-to-Bumper Limited Warranty for 3 years or 36,000 miles and a Powertrain Limited Warranty for 5 years or 60,000 miles, whichever comes first.

Taking the extra time to ensure the best possible structure is exactly what you deserve, and this is why Thor Motor Coach insists on vacuum-bond laminating not only the sidewalls of the motorhome, but also the floor and roof. Vacuum-bonding is the optimum manufacturing process to ensure multi-layer integrity.



ROOF

- A** One-piece exterior TPO membrane
- B** Luan panels
- C** Aluminum structure with bowed framing
- D** Block foam insulation
- E** Interior panel with soft touch or hard vinyl covering

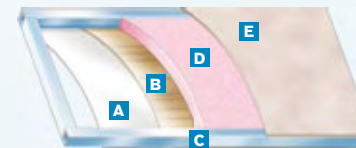

SIDEWALLS

- A** High-gloss or gel-coat fiberglass
- B** Luan panels
- C** Aluminum structure with framing at all openings
- D** Block foam insulation
- E** Interior panel with designer wall covering



FLOOR

- A** Residential vinyl flooring or carpet
- B** OSB structure wood base
- C** Structural steel framing
- D** Block foam insulation
- E** Luan with woven plastic exterior finish

CLASS C FLOOR PLAN

29H

Chassis	Ford
Gross Vehicle (GVWR)	14,500
Gross Combined (GCWR)	22,000
Wheel Base	219"
Exterior Length	30'-9"
Exterior Height (w/AC)	10'-10"
Exterior Width (w/o mirrors)	99"
Interior Height (living area)	82"
Awning Size	16'
Fuel (gal)	55
LPG (lbs)	40.9
Fresh/Waste/Gray Water (gal)	40 / 31 / 32
Water Heater (gal)	6
Furnace (BTUs)	20,000
Exterior Storage Capacity (cu. ft.)	13.4 (plus Garage)

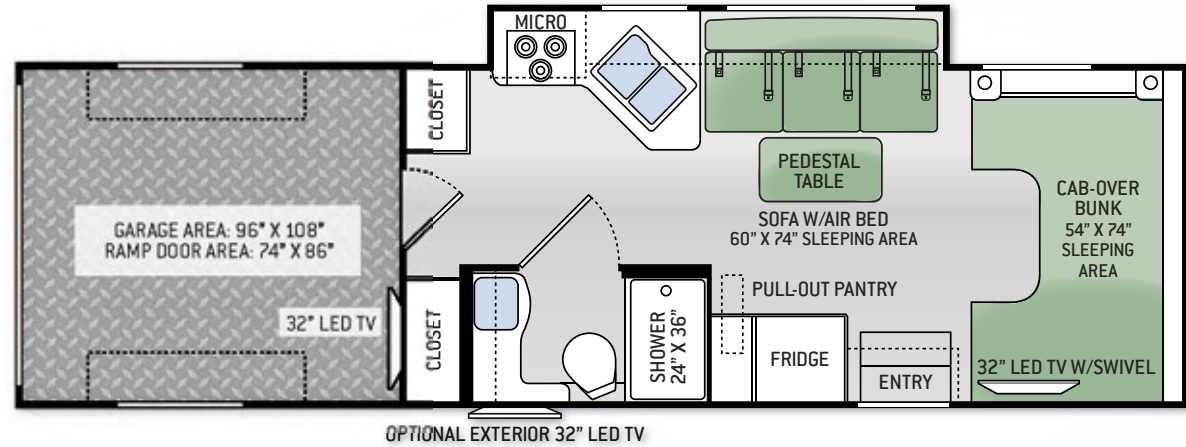

CLASS C STANDARDS & OPTIONS

EXTERIOR & CONSTRUCTION

- Ford® E-450 Chassis – 6.8L Triton® V10, 305HP & 420 lb.-ft. Torque – TorqShift® 5-Speed Automatic Transmission
- Premium One-Piece Crown TPO Roof
- HD-MAX™ Exterior with Graphics Package
- Rotocast Storage Compartments
- Flush Mount Radius Storage Doors
- Aluminum Running Boards
- Power Patio Awning with Integrated LED Lighting
- Patio & Rear Spot Lights
- Frameless Windows
- Outside Shower
- Drop Down Ramp Door with Patio Railings & Manual Patio Awning
- Air Ventilation Sidewall Vents in Garage

EXTERIOR & CONSTRUCTION OPTION

- Automatic Leveling Jacks with Touchpad Controls

AUTOMOTIVE & COCKPIT

- Touchscreen Dash Radio with DVD/CD Player & Back-Up Monitor
- Heated/Remote Exterior Mirrors with Integrated Side View Cameras

- Leatherette Captain's Chairs
- Keyless Entry
- Windshield Privacy Curtain
- Valve Stem Extenders
- 8,000-lb. Trailer Hitch with 7-pin Round Connector*
- Wheel Liners

AUTOMOTIVE & COCKPIT OPTION

- Power Driver's Seat

INTERIOR

- Residential Vinyl Flooring Throughout
- Tread Plate Non-Slip Flooring in Garage
- Tie Down Rings in Garage
- Ceiling Ducted Air Conditioning System in Living Area
- LED Ceiling Lights
- Raised Panel Cabinet Doors with Nickel Finish Hardware
- Leatherette Sofa with Air Bed & Pedestal Table
- Hard Vinyl Ceiling in Living Area
- Window Privacy Roller Shades

INTERIOR OPTIONS

- Two Opposing Leatherette Jack-Knife Sofas in Garage
- 12-volt Attic Fan in Cab-Over

KITCHEN

- Double Door Refrigerator
- 3-Burner Gas Cooktop
- Convection Microwave Oven
- Laminate Countertops
- Large, Double Bowl Kitchen Sink

KITCHEN OPTION

- 12-volt Attic Fan

BEDROOM & BATHROOM

- Power Vent in Bathroom
- Porcelain Toilet
- Shower with Glass Door

ENTERTAINMENT

- Cab-Over Entertainment Center with 32" LED TV on Manual Swivel & DVD Player
- 32" LED TV in Garage*
- Coach Radio System in Garage
- Power Charging Center for Electronics
- Cable TV Ready

ENTERTAINMENT OPTION

- Exterior 32" LED TV

ELECTRICAL & PLUMBING

- Cummins Onan® RV QG 4000 Gas Generator
- Automatic Shoreline-to-Generator Transfer Switch
- 30-amp Service with Shoreline Power Cord
- 13,500 BTU Front Roof Air Conditioner
- 5,000 BTU Air Conditioner in Garage*
- Battery Disconnect Switch
- Dual Auxiliary House Batteries
- Emergency Start Switch
- 1,000-watt Entertainment Inverter
- 6-gallon DSI Gas/Electric Water Heater
- Water Heater Bypass System
- Systems Control Center
- **Rapid Camp™** Wireless Control System

ELECTRICAL & PLUMBING OPTION

- Holding Tanks with Heat Pads

*INCLUDED ON UNITS BUILT AFTER 10/1/14

SUPER C FLOOR PLAN

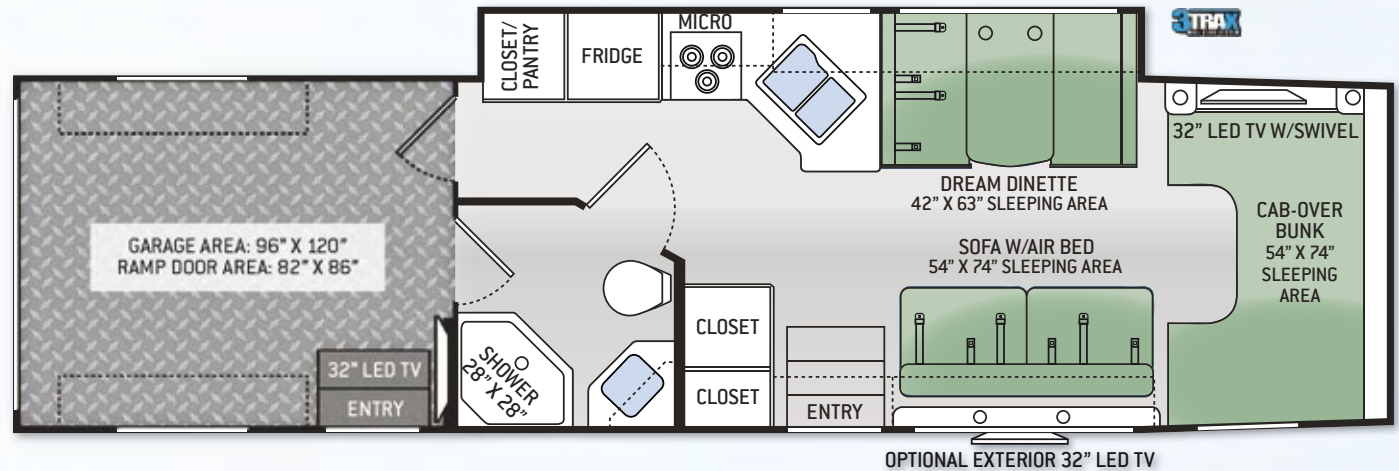

35SG

Chassis	Ford
Gross Vehicle (GVWR)	19,500
Gross Combined (GCWR)	35,000
Wheel Base	255"
Exterior Length	36'-8"
Exterior Height (w/AC)	12'-4"
Exterior Width (w/o mirrors)	99"
Interior Height (living area)	82" (89" in Garage)
Awning Size	20'
Rear/Front Fuel (gal)	40 / 28
LPG (lbs)	68.2
Fresh/Waste/Gray Water (gal)	72 / 40 / 47
Water Heater (gal)	6
Furnace (BTUs)	30,000
Exterior Storage Capacity (cu. ft.)	27 (plus Garage)



SUPER C STANDARDS & OPTIONS

EXTERIOR & CONSTRUCTION

- Ford® F-550 Chassis – 6.7L Power Stroke® V8 Turbo Diesel, 300HP & 660 lb.-ft. Torque – TorqShift® 6-Speed SelectShift® Automatic Transmission
- Premium One-Piece Crown TPO Roof 
- HD-MAX™ Exterior with Graphics Package
- Rotocast Storage Compartments
- Flush Mount Radius Storage Doors
- Automatic Leveling Jacks with Touchpad Controls
- Fiberglass Running Boards
- Power Patio Awning with Integrated LED Lighting
- 3TRAX™ Wall Slide System 
- Patio & Rear Spot Lights
- Frameless Windows
- Outside Shower
- Drop Down Ramp Door with Patio Railings & Manual Patio Awning
- Air Ventilation Sidewall Vents in Garage

EXTERIOR & CONSTRUCTION OPTION

- Full-Body Paint Package with Gel-Coat Sidewalls

AUTOMOTIVE & COCKPIT

- Touchscreen Dash Radio with DVD/CD Player & Back-Up Monitor
- Heated/Remote Exterior Mirrors with Side View Camera System

- Leatherette Captain's Chairs
- Keyless Entry
- Windshield Privacy Curtain
- Valve Stem Extenders
- 10,000-lb. Trailer Hitch with 7-pin Round Connector
- Wheel Liners

INTERIOR

- Residential Vinyl Flooring Throughout
- Tread Plate Non-Slip Flooring in Garage
- Tie Down Rings in Garage
- Ceiling Ducted Air Conditioning System in Living Area
- LED Ceiling Lights
- Raised Panel Cabinet Doors with Nickel Finish Hardware
- Soft Touch Vinyl Ceiling in Living Area
- Leatherette Sofa with Air Bed
- Dream Dinette™ Booth
- Window Solar & Privacy Roller Shades

INTERIOR OPTIONS

- Two Opposing Leatherette Jack-Knife Sofas in Garage
- 12-volt Attic Fan in Cab-Over
- Single Child Safety Tether in Booth Dinette
- Dual Child Safety Tether in Booth Dinette

KITCHEN

- 10 cu. ft. Double Door Refrigerator
- 3-Burner Gas Cooktop with Oven
- 30" Over-the-Range Microwave Oven
- Solid Surface Countertops & Sink Covers
- Pantry
- Large, Double Bowl Kitchen Sink

KITCHEN OPTION

- 12-volt Attic Fan

BEDROOM & BATHROOM

- Power Vent in Bathroom
- Porcelain Toilet
- Skylight in Shower
- Shower with Glass Door

ENTERTAINMENT

- Cab-Over Entertainment Center with 32" LED TV on Manual Swivel & DVD Player
- 32" LED TV in Garage*
- Coach Radio System in Garage
- Power Charging Center for Electronics
- Cable TV Ready

ENTERTAINMENT OPTION

- Exterior 32" LED TV

ELECTRICAL & PLUMBING

- Cummins Onan® RV QG 5500 LP Gas Generator
- Automatic Shoreline-to-Generator Transfer Switch
- 50-amp Service with Detachable Shoreline Power Cord
- 13,500 BTU Front Roof Air Conditioner
- 13,500 BTU Air Conditioner in Garage
- Battery Disconnect Switch
- Dual Auxiliary House Batteries
- Emergency Start Switch
- 1,000-watt Entertainment Inverter
- 6-gallon DSI Gas/Electric Water Heater
- Enclosed, Heated Potable Holding Tanks
- Water Heater Bypass System
- Systems Control Center
- **Rapid Camp™** Wireless Control System

ELECTRICAL & PLUMBING OPTION

- Cummins Onan® RV QD 6000 Diesel Generator

*INCLUDED ON UNITS BUILT AFTER 10/1/14



MORE THAN JUST A MOTORHOME

The Outlaw Class A expands the limits of what a motorhome could be. Unique, distinctive floor plans, interiors, and sleeping spaces put the Outlaw in a class of its own. When you're ready to get out of the ordinary and into the extraordinary, the Outlaw has no equal.



37MD | BROWN SUGAR | OLYMPIC CHERRY



38RE | MOONDANCE | OLYMPIC CHERRY



37MD | BROWN SUGAR | OLYMPIC CHERRY



37LS | METALLIC | OLYMPIC CHERRY



CLASS A



BEAUTY INSIDE & OUT



BROWN SUGAR



CHILI PEPPER



METALLIC

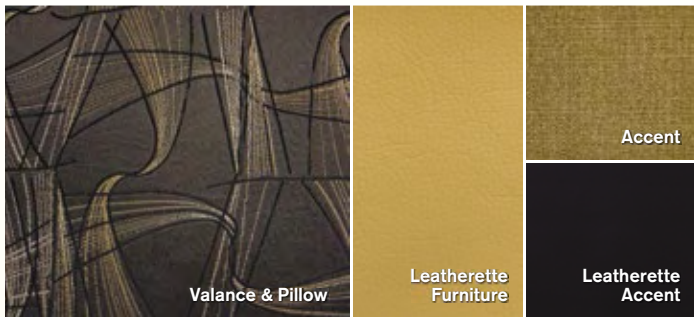

MOONDANCE



FLOORING

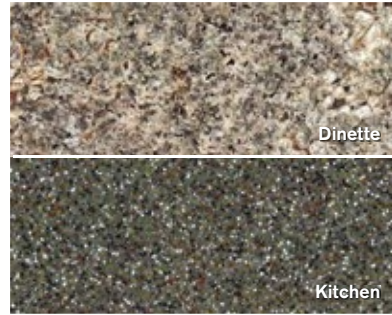

COUNTERTOPS

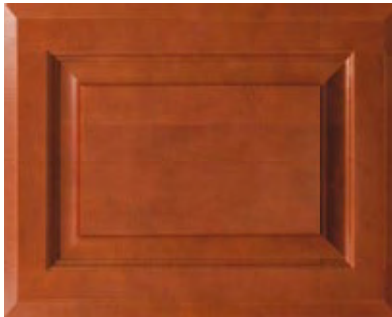

OLYMPIC CHERRY

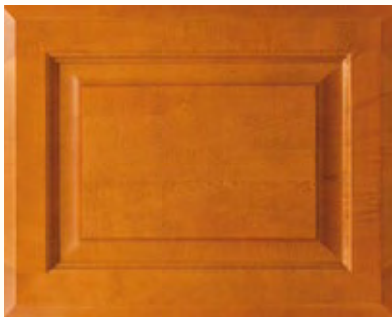

VINTAGE MAPLE



DREAM CATCHER FULL-BODY PAINT



LIQUID ASSET FULL-BODY PAINT



ROCK ISLAND FULL-BODY PAINT



TANGO RED FULL-BODY PAINT



A | TRITON® V10 ENGINE

The 6.8L V10 engine has a proven track record of durability and low-hassle maintenance. Extremely smooth running with a commanding 362-horsepower and 457 lb.-ft. of torque.

B | POWER 4-WHEEL DISC ANTI-LOCK BRAKES

Maintains brake balance in heavy use and varying road conditions. Reduces wheel lock up and helps maintain superior steering control.

C | BILSTEIN SHOCKS

Long lasting, rugged shocks provide greater stability and better road handling.

D | TORQSHIFT™ 5-SPEED AUTOMATIC TRANSMISSION

Provides crisp, firm and quick shifting without sacrificing driver comfort.

E | LIMITED WARRANTY

The Ford® Motorhome Chassis has a Bumper-to-Bumper Limited Warranty for 3 years or 36,000 miles and a Powertrain Limited Warranty for 5 years or 60,000 miles, whichever comes first.

Taking the extra time to ensure the best possible structure is exactly what you deserve, and this is why Thor Motor Coach insists on vacuum-bond laminating not only the sidewalls of the motorhome, but also the floor and roof. Vacuum-bonding is the optimum manufacturing process to ensure multi-layer integrity.



- ROOF**
- A** One-piece exterior TPO membrane
 - B** Luan panels
 - C** Aluminum structure with bowed framing
 - D** Block foam insulation
 - E** Interior panel with soft touch vinyl covering

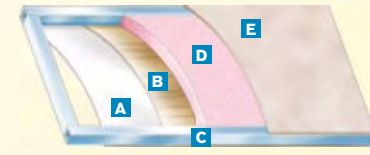

- SIDEWALLS**
- A** High-gloss or gel-coat fiberglass
 - B** Luan panels
 - C** Aluminum structure with framing at all openings
 - D** Block foam insulation
 - E** Interior panel with designer wall covering

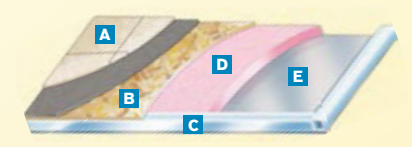

- FLOOR**
- A** Residential vinyl flooring or carpet
 - B** OSB structure wood base
 - C** Structural steel framing
 - D** Block foam insulation
 - E** Luan with woven plastic exterior finish

CLASS A FLOOR PLANS

37LS

Chassis	Ford
Gross Vehicle (GVWR)	26,000
Gross Combined (GCWR)	30,000
Wheel Base	252"
Exterior Length (w/o ladder)	38'-6"
Exterior Height (w/AC)	13'-3"
Exterior Width (w/o mirrors)	101"
Interior Height	80"-97"
Awning Size	21'
Fuel (gal)	80
LPG (lbs)	105
Fresh/Waste/Gray Water (gal)	100 / 43 / 43
Water Heater (gal)	6
Furnace (BTUs)	35,000
Exterior Storage Capacity (cu. ft.)	132

37LS

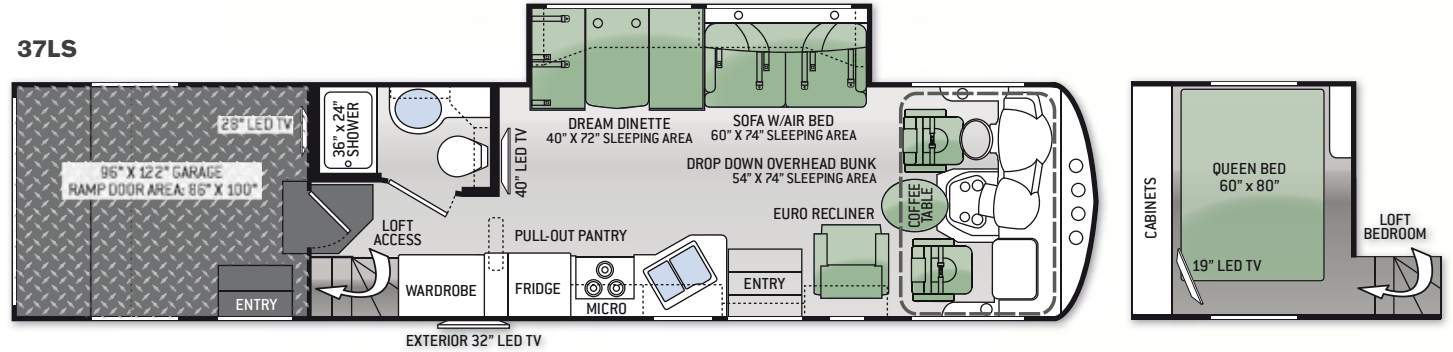

37MD

Chassis	Ford
Gross Vehicle (GVWR)	26,000
Gross Combined (GCWR)	30,000
Wheel Base	252"
Exterior Length (w/o ladder)	38'-9"
Exterior Height (w/AC)	13'-3"
Exterior Width (w/o mirrors)	101"
Interior Height	80"-97"
Awning Size	9' / 13'
Fuel (gal)	80
LPG (lbs)	105
Fresh/Waste/Gray Water (gal)	100 / 43 / 43
Water Heater (gal)	6
Furnace (BTUs)	35,000
Exterior Storage Capacity (cu. ft.)	127

37MD

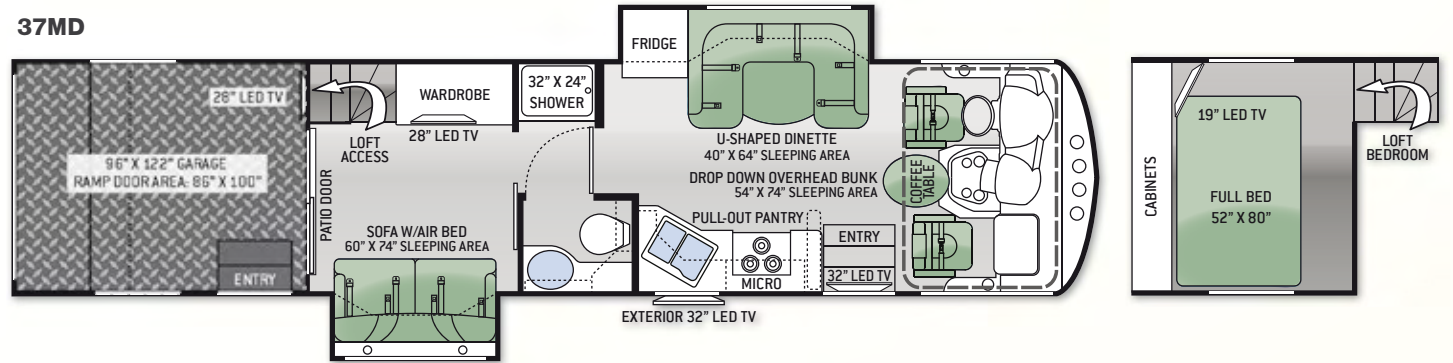

38RE

Chassis	Ford
Gross Vehicle (GVWR)	26,000
Gross Combined (GCWR)	30,000
Wheel Base	252"
Exterior Length (w/o ladder)	39'-11"
Exterior Height (w/AC)	13'-3"
Exterior Width (w/o mirrors)	101"
Interior Height	80"-105"
Awning Size	19'
Fuel (gal)	80
LPG (lbs)	105
Fresh/Waste/Gray Water (gal)	150 / 40F - 29R / 43
Water Heater (gal)	6
Furnace (BTUs)	35,000 F - 20,000 R
Exterior Storage Capacity (cu. ft.)	158

38RE

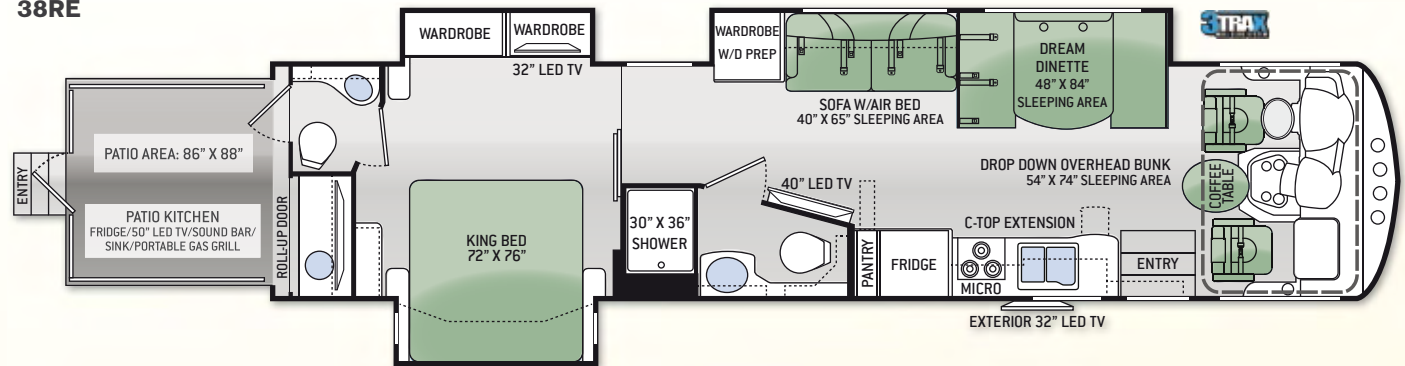

CLASS A STANDARDS & OPTIONS

CONSTRUCTION & EXTERIOR

- Ford F-53 SuperDuty Chassis - 6.8L Triton® V10 Engine, 362HP, 457 lb.-ft. Torque - TorqShift® 5-Speed Automatic with Overdrive Transmission
- Fully Welded Tubular Steel Floor System
- Fully Welded Tubular Aluminum Roof & Sidewall Cage Construction
- Vacu-Bond Laminated Roof, Sidewalls and Floor with High-Density Block Foam Insulation
- Fiberglass Front Cap
- One-Piece Windshield
- Full-Body Paint Package with Gel-Coat Sidewalls
- Automatic Leveling Jacks with Touchpad Controls
- Full Basement Pass-Through Storage
- Rotocast Storage Compartments
- Power Patio Awning with Integrated LED Lighting
- 3TRAX™ Wall Slide System (38RE) 
- Rear Spot Lights
- Patio Lights
- Double Electric Exterior Entrance Step
- Outside Shower
- Remote Fuel Filling Station with Pump & Nozzle (37LS & 37MD)
- Frameless Windows
- Drop Down Ramp Door w/Spring Assist, Patio Railings & Manual Patio Awning (37LS & 37MD)
- Drop Down Patio Deck w/Railings, Staircase to Ground Level & Manual Patio Awning (38RE)
- Air Ventilation Sidewall Vents in Garage (37LS & 37MD)

CONSTRUCTION & EXTERIOR OPTION

- Frameless Dual Pane Windows

AUTOMOTIVE & COCKPIT

- Touchscreen AM/FM Dash Radio with CD Player, Bluetooth® & Back-Up Monitor
- Heated/Remote Exterior Mirrors with Integrated Side View Cameras
- Reclining/Swivel Leatherette Captain's Chairs
- Stow-Away Coffee Table between Captain's Chairs
- Cruise Control
- Tilt Steering Wheel
- Electric Windshield Solar & Privacy Shades
- Dash Fans
- Map Light
- 22.5" Tires with Aluminum Wheels
- 8,000-lb. Trailer Hitch with 7-pin Round Connector*
- Rear Mud Flap
- Dash Workstation with 110-volt & 12-volt Outlets

INTERIOR

- Residential Vinyl Flooring Throughout
- Ceiling Ducted Air Conditioning System in Living Area (37LS & 37MD includes Loft)
- Solid Wood Raised Panel Cabinetry with Nickel Finish Hardware
- 80" Interior Height (At Lowest Point)
- Vaulted Ceiling (38RE)
- LED Ceiling Lights
- Soft Touch Vinyl Ceiling
- Leatherette Sofa with Air Bed (37LS & 38RE)
- Leatherette Euro Recliner (37LS)
- Sofa Pillows
- Leatherette Dream Dinette™ Booth (37LS & 38RE)
- Leatherette U-Shaped Dinette (37MD)
- Power Drop-Down Hide-Away Overhead Bunk*
- Window Solar & Privacy Roller Shades in Living Area

- Tread Plate Non-Slip Flooring, Tie Down Rings & Stainless Steel Storage Cabinet in Garage (37LS & 37MD)
- 12-volt Attic Fan in Garage (37LS & 37MD)

INTERIOR OPTION

- Two Opposing Jack-Knife Sofas in Garage (37LS & 37MD)

KITCHEN

- Double Door Refrigerator (37LS & 37MD)
- 18 cu. ft. Residential Refrigerator (38RE)
- 3-Burner Gas Cooktop with Oven
- 30" Over-the-Range Microwave Oven
- Solid Surface Countertop & Sink Cover
- Large Double Bowl Sink with Single Handle Kitchen Faucet & Sprayer
- 12-volt Attic Fan

BEDROOM & BATHROOM

- Denver Mattress® King Size Bed with Designer Headboard (38RE)
- Queen Size Bed in Loft (37LS)
- Full Size Bed in Loft (37MD)
- Leatherette Sofa with Air Bed in Main Floor Bedroom (37MD)
- Bedspread & Pillow Shams
- Privacy Curtain in Loft (37LS)
- Window Privacy Roller Shades in Loft (37LS & 37MD)
- 12-volt Attic Fan in Bathroom
- Foot Flush Porcelain Toilet
- Shower with Glass Door

ENTERTAINMENT

- Mid-Ship Entertainment Center with 40" LED TV & DVD Player in Living Area (37LS & 38RE)
- Entertainment Center with 32" LED TV & DVD Player in Living Area (37MD)
- 19" LED TV in Loft Bedroom (37LS & 37MD)

- 28" LED TV in Main Bedroom (37MD)
- 32" LED TV in Bedroom (38RE)
- 28" LED TV in Garage (37LS & 37MD)
- Exterior 32" LED TV
- Cable TV & HDMI Ready
- Bluetooth® Coach Radio System with Exterior Speakers
- Power Charging Center for Electronics
- Rear Patio Outside Kitchen including 50" LED TV, Bluetooth® Sound Bar, 2.5 cu. ft. Refrigerator, Sink & Portable Gas Grill (38RE)

ELECTRICAL & PLUMBING

- Cummins Onan® RV QG 5500 Gas Generator
- 50-amp/120-volt Service
- Dual 13,500 BTU Low Profile Roof Air Conditioners
- 5,000 BTU Air Conditioner in Garage (37LS & 37MD)
- 5,000 BTU Air Conditioner with Remote in Bedroom (38RE)
- Emergency Start Switch
- Battery Disconnect Switch
- Dual Auxiliary House Batteries
- 1000-watt Inverter (37LS & 37MD)
- 1800-watt Inverter (38RE)
- 6-gallon DSI Gas/Electric Water Heater
- Water Heater Bypass System
- Enclosed/Heated Holding Tanks
- Black Tank Water System
- Washer/Dryer Prep (37LS & 38RE)
- Systems Control Center
- **Rapid Camp™** Wireless Control System

*INCLUDED ON UNITS BUILT AFTER 10/11/14



IT'S NEVER BEEN THIS EASY.

Whether you choose a Class C or Class A Outlaw, you can entertain or relax on on your own ultimate patio deck. Safety railings line the edges of the deck for peace of mind while the garage Bluetooth-equipped radio lets you enjoy the big game or your favorite tunes!



OPTIONAL JACK-KNIFE SOFAS (N/A 38RE)



NON-SLIP FLOORING & TIE-DOWN RINGS



38RE | PATIO DECK FEATURING KITCHEN & 50" LED TV





35SG | PATIO DECK WITH SAFETY RAILINGS





Thor Motor Coach is the industry leader in innovative design and builds a variety of unique styles, sizes and floor plans that feel custom-made – at a truly competitive price.

IMPORTANT - PLEASE READ: This brochure reflects product design, fabrication, material, components and specifications at the date of printing, which date is disclosed on the last page. PLEASE VISIT US ONLINE AT THORMOTORCOACH.COM OR CONSULT WITH YOUR SELLING DEALERSHIP FOR THE LATEST IN STANDARDS, OPTIONS, SPECIFICATION AND TECHNICAL INFORMATION. Photographs in the brochure may depict optional equipment or may only be available in certain floor plans. Components, appliances and the chassis may have been manufactured in a calendar year before the vehicle's designated model year. All capacities are approximate. The actual length of the vehicle may differ from that indicated in the brochure due to variances in the manufacturing processes and/or installed components. All dry weights are based on standard model features and do not include optional features or equipment. Component part and appliance manufacturers issue limited warranties covering portions of the vehicle not covered under the limited warranty we issue.

Copyright Thor Motor Coach, Inc. © 12/15/14

YOUR LOCAL THOR MOTOR COACH DEALER



Made to fit.

P.O. Box 1486, Elkhart, IN 46515
Sales Department: 800.860.5658
Customer Service: 877.855.2867



OutlawRV.com